

JUDY KENT
FAY HUMPHREY
DB 4-S PG 414-416
PB 3 PG 316

ROY AARON
DB 307 PG 308
PB 3 PG 87

WAYNE H. FORDHAM
MARTHA L. FORDHAM
DB 3-P PG 487
PB 12 PG 86

S 76°52'20"E
241.02'
S 32°24'29"E
307.89'
S 26°05'19"E
361.91'

TRACT 13
34.9± ACRES

TRACT 12
25.8± ACRES

TRACT 1
70.12 ACRES

TRACT 2
86.72 ACRES (UNDER TRAVERSE LINES)
+1.97 ± ACRES (BETWEEN TRAVERSE LINES & S. CREEK)
88.69 ± ACRES

NAIL
GRID COORDINATES
N 963274.08 E 711182.98
SF: 0.999991643
NOTE: ALL DISTANCES SHOWN ARE GROUND.

JOSEPH SMILEY LEE
DB 3-A PG 814
PB 5 PG 176

NOTES:

- THIS SURVEY WAS PERFORMED WITH A TOPCON GTS-303 TOTAL STATION, A 100' TAPE, AND PROMARK 500 GNSS SURVEYING SYSTEM.
- ACCURACY OF FIELD WORK ACQUIRED TO PREPARE THIS PLAT
 - TOPCON GTS-303 TOTAL STATION ANGULAR ERROR OF 00°00'04" PER POINT AND CLOSURE PRECISION ONE FOOT IN 10,643 (UNADJUSTED) AND ONE FOOT IN 19,534 (ADJUSTED).
 - PROMARK GNSS SURVEYING SYSTEM (REAL TIME NETWORK) HORIZONTAL POSITIONAL ERROR TOLERANCE AT 95% CONFIDENCE LEVEL IS 0.08'.
- THIS PLAT HAS A CLOSURE PRECISION THAT EXCEEDS ONE FOOT IN 100,000 FEET.

GLORIA B. ELLISON
DB 3-M PG 31
PB 6 PG 176

ANTHONY W. MARTIN
DB 5-F PG 137
PB 3 PG 290

NORMAN SCALF
DB 3-L PG 531-532
PB 5 PG 176

ANTHONY W. MARTIN
DB 5-F PG 137
PB 3 PG 290

LEGEND

- IPF - IRON PIPE FOUND
- IPS - IRON PIPE SET
- AIF - ANGLE IRON FOUND
- AIS - ANGLE IRON SET
- CTF - CRIMPED TOP PIPE FOUND
- CMF - CONC. MONUMENT FOUND
- CMS - CONC. MONUMENT SET
- RF - REBAR FOUND
- RBS - REBAR SET
- SOIF - SQUARE IRON FOUND
- OTF - OPEN TOP PIPE FOUND
- RRI - RAILROAD IRON
- CSS - COTTON SPIKE SET
- CSF - COTTON SPIKE FOUND
- *-*- - FENCE
- - - - FLOOD HAZARD

File No. _____
Hour Filed _____
Date Filed _____

Deputy Clerk Superior Court
Jenkins County, Georgia

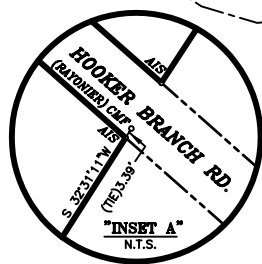

REFERENCES:
DB RR PG 499-500
PB 4 PG 132

PROPOSED DIVISION OF A PLAT OF SURVEY FOR
TERRAPOINTE LLC
BEING TRACT 2010-2-4 AND LOCATED IN THE 1640th. G.M.D.
JENKINS COUNTY, GEORGIA
SCALE: 1" = 300'
JANUARY 13, 2010
Prepared by
STEVE BARGERON & ASSOCIATES
WAYNESBORO, GEORGIA (706)844-8888